



## **M3 8K Wireless Mouse User Manual**

## **IN THE BOX:**

Mouse x 1

Type - C Cable x 1

Extension Adapter x 1

Type - A Receiver x 1

User Manual x 1

Type - A to Type - C Adapter x 1

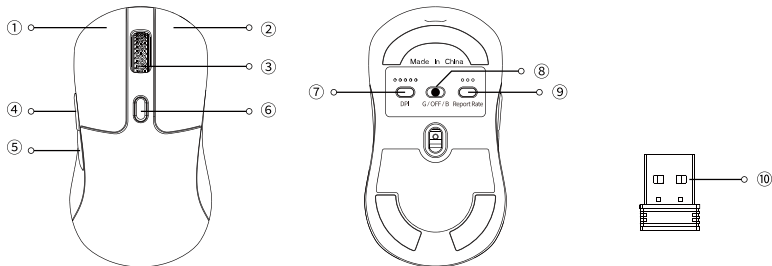

- ① Left button      ② Right button      ③ Middle wheel button      ④ Forward button      ⑤ Backward button  
⑥ Middle button      ⑦ DPI button      ⑧ Modes toggle      ⑨ Report rate button      ⑩ 2.4GHz Type - A receiver

## 3 Modes of connection

### Wired Mode:

1. When the mode switch is in "OFF" position, the mouse won't respond if the cable is not connected.
  2. Connect the cable to the TYPE-C port of the mouse and the USB port on the device. The mouse is ready to use while the backlit lights up.
- \* When connected by cable, the mode will default to wired mode even if the toggle is in Bluetooth mode or 2.4GHz mode.

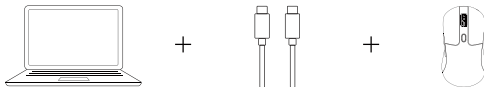

### 2.4GHz Mode:

1. Switch to "G" mode (2.4GHz mode), and the mouse will automatically turn on 2.4GHz pairing. The RGB light on the mouse wheel will slowly flash green.
2. Find the 2.4GHz receiver and connect it to the device's USB. Once successfully connected, the RGB light on the mouse wheel will turn green and stay on for 3 seconds, then dims off.

3. In 2.4GHz pairing mode, the RGB light on the side of the mouse wheel will slowly blink green for 3 minutes. If it's not connected within 3 minutes, the RGB light on the mouse wheel will turn off. If you need to reconnect, hold both the "Left button + Forward button" for 3 seconds to re-enter pairing mode.

\* If you need to repair the connection in 2.4GHz mode, please unplug the 2.4GHz receiver first. Then, hold both the "Left button + Forward button" for 3 seconds, wait for the green light indicator to start flashing, and plug the 2.4GHz receiver back in to complete the pairing process.

Note: It is recommended that when pairing the mouse in 2.4GHz mode, the mouse should be within 20cm of the receiver.

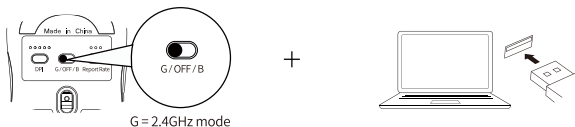

Simultaneously hold for 3 seconds  
(to enter the forced pairing mode)

Note: For the best wireless experience, we recommend using the extension adapter for receiver and putting the 2.4GHz receiver somewhere on your desk close to your mouse for a lower rate of latency and fewer signal interferences.

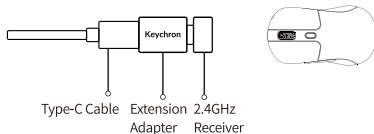

## Bluetooth mode

1. Switch to "B" Mode (Bluetooth), and the mouse will automatically turn on Bluetooth pairing mode. The RGB light on the side of the mouse wheel will slowly flash blue.
2. Open the Bluetooth settings, search for a device named "Keychron M3 8K", then click "connect" to complete pairing.
3. When in Bluetooth pairing mode, the RGB light on the side of the wheel will slowly blink in blue for 3 minutes. If it's not connected within 3 minutes, the RGB light on the mouse wheel will turn off. If you need to reconnect, you need to hold the "Left button + Forward button" for 3 seconds to re-enter pairing mode. The mode indicator will slowly blink blue.
4. If the mouse is in Bluetooth mode and needs to pair with a new device, hold both the "Left button + Forward button" for 3 seconds and wait for the blue light to flash on. At this point, Bluetooth has re-entered pairing mode, and you can connect the new device to the mouse.



Simultaneously hold for 3 seconds  
(to re-enter pairing mode)

## Status indicator

2.4GHz Mode	When the indicator on the side of the mouse wheel: *Slowly blinks green - Ready to be paired. *Quickly blinks green - Pairing with the previous device.
Bluetooth Mode	When the indicator on the side of the mouse wheel: *Slowly blinks blue - Ready to be paired. *Quickly blinks blue - Pairing with the previous device.
Low power	The indicator on the side of the mouse wheel will slowly blinks red.

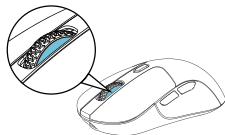

## DPI indicator

White light	400 DPI	Yellow light	3200 DPI
Green light	800 DPI	Red light	5000 DPI
Blue light	1600 DPI (default)		

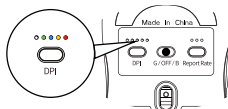

## Report Rate indicator

Report rate indicator	Report rate / Hz	Available modes
White light	125	2.4G / BT / Wired
Blue light	500	2.4G / Wired
Red light	1000	2.4G / Wired(default)
White + Blue light	2000	2.4G / Wired
White + Red light	4000	2.4G / Wired
White + Blue + Red light	8000	2.4G / Wired

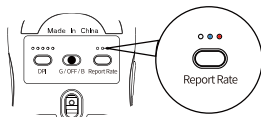



## Auto-Sleep mode

Auto-Sleep mode will not be activated when in wired mode. When in 2.4GHz mode or Bluetooth mode, the mouse will go to Auto-Sleep mode after 15 minutes of sitting idle to save the battery. Move or click the mouse to wake it up.

## Driver Software

The Keychron M3 8K mouse driver can be selected on [launcher.keychron.com](https://launcher.keychron.com). If the driver software can't connect to the mouse, please contact us for technical support.

## How to factory reset

Hold down both the "DPI button" and "Report rate button" for 3 seconds, and all the LED lights on the mouse will blink. It will blink three times to indicate that the factory reset is successful.

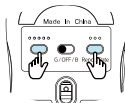

Simultaneously hold for 3 seconds  
(starts factory reset)

## Charging indicator explanation

Fully Charged	The RGB light on the side of the mouse wheel will stay GREEN for 10s and then light off.
Low Power	The RGB light on the side of the mouse wheel will slowly blink RED.

\* The mouse is compatible with all USB ports. For the best signal and charging speed, connecting to the USB3.0 port is recommended when charging or in use.

\* If the mouse is connected by the USB Type - C cable when charging but not paired with any devices:

- The RGB light on the side of the mouse wheel will stay RED for 10s and then light off when charging.
- The RGB light on the side of the mouse wheel will stay GREEN for 10s and then light off when fully charged.

Note: The product supports up to 5V charging voltage and 300mA charging current. We are not responsible for any problems caused by improper recharging.

## Mouse specification

Size	125*68*41mm	Battery capacity	600mAh
Weight	79 ± 3g	Usage duration	140 Hours (Bluetooth mode) 120 Hours (1000Hz) 45 Hours (4000Hz) 40 Hours (8000Hz)
Report Rate (polling rate)	125Hz(White) - 500Hz(Blue) - 1000Hz(Red) 2000Hz(White + Blue) - 4000Hz(White + Red) 8000Hz(White + Blue + Red)		
Sensor	PixArt 3950	Recharge time	2.5 Hours
Resolution	100 - 30000DPI	Charging port	Type - C
Mouse micro switches	Kailh GM8.0 (80 million clicks life time)	Connection mode	2.4GHz - Bluetooth - Wired
2.4GHz / Bluetooth connection range	Approx 10m of open space	Device name	Keychron M3 8K

**Keychron, Inc.**

**Dover, DE 19901, United States**

Find us at:

<https://www.keychron.com>

[support@keychron.com](mailto:support@keychron.com)

 @keychron

 @keychron

 @keychronMK

Designed by Keychron

Made in China



# M3 8K无线鼠标使用说明

# 内容清单

鼠标 x 1

Type - C 线材 x 1

接收器延长器 x 1

Type - A 接收器 x 1

说明书 x 1

Type - A to Type - C 转接头 x 1

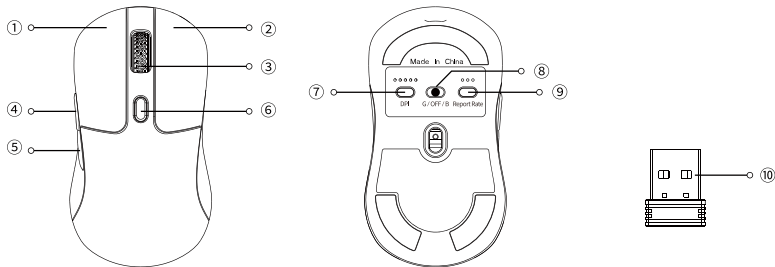

① 左键

② 右键

③ 中键滚轮

④ 前进键

⑤ 后退键

⑥ 中键

⑦ DPI按钮

⑧ 模式拨片

⑨ 回报率按钮

⑩ 2.4G Type-A接收器

## 三模连接方式

### 有线模式：

- 1、在OFF档位下，无连接USB线材，鼠标无任何反应。
  - 2、将数据线连接至鼠标Type-C接口以及设备USB接口，鼠标滚轮下指示灯亮起即可使用。
- \* 即使模式开关是在蓝牙或者2.4G的档位下，当数据线连接上设备后，鼠标将默认为有线模式使用。

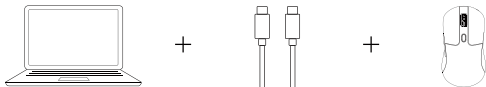

### 2.4G模式：

- 1、将鼠标底部开关拨动到“G”模式档位（2.4G模式）。鼠标自动进入2.4G配对模式，滚轮下指示灯绿灯慢闪。
- 2、将鼠标2.4G接收器连接至设备端的USB，连接成功后，滚轮下指示灯绿灯常亮3秒后熄灭。



3、在2.4G模式下，滚轮下指示灯绿灯将会慢闪并持续三分钟，如果没有在三分钟内进行连接使用，滚轮下指示灯灯光熄灭。

如需重新配对，可以同时长按鼠标左键 + 前进键3秒，重新进入匹配状态。

\* 如果需要重新进行2.4G模式的连接，首先请拔出2.4G接收器。然后同时长按鼠标左键 + 前进键3秒，等待滚轮下指示灯绿灯开始闪烁，之后重新插入2.4G接收器完成配对操作。

注意：进行2.4GHz模式强制配对时，建议鼠标与接收器的距离不超过20cm。

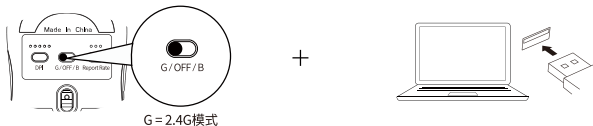

注意：为了获得最佳的无限体验，我们建议将2.4G接收器插入线材+赠送的转接头，放置在书桌上靠近你的鼠标，以降低延迟率和更少的干扰信号。

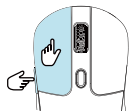

同时保持3秒  
(进入强制配对模式)

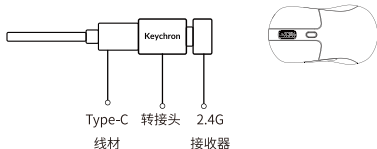

## 蓝牙模式

- 1、将鼠标底部开关拨动到“B”模式档位（蓝牙模式）。鼠标自动进入蓝牙配对模式，滚轮下指示灯蓝灯慢闪。
- 2、此时打开设备蓝牙设置，搜索设备：Keychron M3 8K，点击连接即可使用。
- 3、拨动到蓝牙模式下，滚轮下指示灯蓝灯将会慢闪并持续三分钟，如果没有在三分钟内进行连接使用，滚轮下指示灯熄灭。  
如需重新配对，可以同时长按鼠标左键 + 前进键3秒，即可重新进入配对模式，滚轮下指示灯蓝灯持续慢闪。
- 4、如果鼠标在蓝牙模式下需要与其他新设备进行连接，可以同时长按鼠标左键 + 前进键3秒，滚轮下指示灯将会蓝灯慢闪，即可重新进入鼠标蓝牙配对状态。此时您可以让新设备与鼠标进行连接。



同时保持3秒  
(重新进入配对模式)

## 功能指示灯说明

2.4G模式	滚轮下指示灯(绿灯)慢闪-配对 滚轮下指示灯(绿灯)快闪-回连
蓝牙模式	滚轮下指示灯(蓝灯)慢闪-配对 滚轮下指示灯(蓝灯)快闪-回连
低电状态	滚轮下指示灯(红灯)慢闪

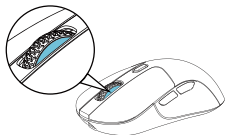

## DPI 指示灯

白灯	400 DPI	黄灯	3200 DPI
绿灯	800 DPI	红灯	5000 DPI
蓝灯	1600 DPI(默认)		

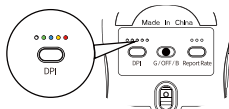

## 回报率指示灯

回报率指示灯	回报率 / Hz	模式
白灯	125	2.4G / BT / 有线
蓝灯	500	2.4G / 有线
红灯	1000	2.4G / 有线 (默认)
白灯+蓝灯	2000	2.4G / 有线
白灯+红灯	4000	2.4G / 有线
白灯+蓝灯+红灯	8000	2.4G / 有线

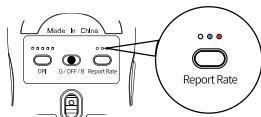

## 休眠模式

有线模式下无休眠状态, 2.4G模式和蓝牙模式下, 鼠标无操作15分钟后自动进入休眠状态, 移动或者点击操作即可唤醒鼠标。

## 驱动软件

可以在[launcher.keychron.com](http://launcher.keychron.com)选择Keychron M3 8K鼠标驱动, 如驱动软件无法连接鼠标, 请联系我们提供技术支持。

## 恢复出厂模式

同时长按DPI按钮与回报率按钮3秒, 鼠标整体LED灯光闪烁, 闪烁三次代表恢复出厂设置成功。

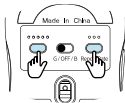

同时保持3秒  
(开始恢复出厂设置)

## 充电指示灯说明

电量充满时	滚轮下指示灯绿灯常亮10秒后熄灭
低电量时	滚轮下指示灯红灯慢闪

\*鼠标与所有USB端口兼容,如需获得最佳信号以及充电速度,建议连接USB3.0端口进行充电和使用。

\*鼠标如果连接充电线充电,

充电中:滚轮下指示灯红灯常亮10秒后熄灭。

充满时:滚轮下指示灯绿灯常亮10秒后熄灭。

注意:本产品最高支持5V充电电压,300mA充电电流。因不当充电而导致的问题,概不负责。

## 鼠标规格

尺寸	125*68*41mm	电池容量	600mAh
重量	79±3g	续航	140小时(蓝牙模式下) 120小时(1000Hz) 45小时(4000Hz) 40小时(8000Hz)
回报率	125Hz(白灯)-500Hz(蓝灯)-1000Hz(红灯) 2000Hz(白灯+蓝灯)-4000Hz(白灯+红灯) 8000Hz(白灯+蓝灯+红灯)		
传感器	PixArt 3950	充电时间	2.5小时
分辨率	100-30000DPI	充电端口	Type-C
微动开关	凯华GM8.0(8000万次)	使用模式	2.4G-蓝牙-有线
2.4G / 蓝牙模式 工作距离	开放环境下约10米	设备名称	Keychron M3 8K

**Keychron, Inc.**  
**Dover, DE 19901, United States**

<https://www.keychron.com>

通过以下方式与我们联系

[support@keychron.com](mailto:support@keychron.com)

 @keychron

 @keychron

 @keychronMK

Keychron设计

中国制造

中国区总代：渴创技术（深圳）有限公司

执行标准：GB 4943.1-2022

售后热线：400-0766268

地 址：深圳市龙岗区坂田街道大发埔社区  
大发路24号文坑工业区2栋201